

BLACK DIAMOND

1. Black Diamond plazovni NAHRBTNIK HALO JETFORCE 28L
Velikosti S/M ali M / L, barva črna
MPC: 1050,00 eur za GRS 869,00 eur



HALO 28 JETFORCE nahrbtnik je primeren za turne smučarje in freeriderje, ima napihljivo varnostno plazovno zračno blazino JetForce, poseben žep za lavinsko opremo, izdelan iz JetForce Technology in je primeren za eno ali večdnevne ture.

Značilnosti

Zračno hrbtnišče z naramnicami reActiv in SwingArm, ki se premikajo oziroma nihajo, zato je gibanje z nahrbtnikom svobodnejše in lahkotnejše

Varnostna blazina izdelana po tehnologiji JetForce ohranja ponesrečenca na površini plazu in zmanjša nevarnost prevračanja. Je izredno trpežna, se lahko ponovno napolni in je prijazna za nošenje

Žep za lavinsko opremo in možnosti pripenjanja lednega orodja

Smuči se lahko pripnejo diagonalno in tudi v tem primeru se lahko zračna blazina napihne

Notranji žep za opremo, žep na pasu in sistem HiLo za pritrditev čelade.

2. Black Diamond plazovni NAHRBTNIK SAGA JETFORCE 40L
Velikosti S/M ali M / L, barva črna
MPC 1100,00 eur za GRS 909,00 eur



SAGA 40 JETFORCE nahrbtnik je idealen za smučarske nadzornike, vrhunske smučarje in turnosmučarske ture od kočje do kočje.

Saga 40 je naš največji zmogljiv nahrbtnik, ki vključuje JetForce tehnologijo, napihljivo varnostno plazovno zračno blazino JetForce in poseben žep za lavinsko opremo.

Zračno hrbtnišče z naramnicami reActiv in SwingArm, ki se premikajo oziroma nihajo, zato je gibanje z nahrbtnikom svobodnejše in lahkotnejše

Varnostna blazina izdelana po tehnologiji JetForce ohranja ponesrečenca na površini plazu in zmanjša nevarnost prevračanja. Je izredno trpežna, se lahko ponovno napolni in je prijazna za nošenje

Žep za lavinsko opremo in PickPockets™ žep za ledno orodje

Smuči se lahko pripnejo diagonalno in tudi v tem primeru se lahko zračna blazina napihne

Notranji žep za opremo, žep na pasu in sistem HiLo za pritrditev čelade.

3. Black Diamond sonda Quickdraw 240:

MPC 44,90 eur za GRS 35,00 eur



DESCRIPTION

With a shorter length ideal for lightweight tours, avalanche rescue practice and skiing terrain with shallow snowpacks, the Black Diamond Quickdraw Probe Tour 240 features a durable aluminum construction. The Tour 240's updated ferrules make for increased durability and quick alignment, while the integrated stuff sack and non-slip grip make for fast, one-pull deployment in emergency situations.

Updated dual Quickdraw speed ferrules make for extremely fast deployment with maximum durability

Rapid deployment stuffsack integrates with the probe's pull cord for one-pull readiness

Non-slip grip provides secure purchase, even with wet gloves

Oversized, durable alloy tip improves probing sensitivity by creating a hole larger than the probe shaft

High-visibility 1 cm markings

TECH SPECS

Weight : 303 g (11 oz)

Length : 240 cm (94 in)

4. Black Diamond sonda Quickdraw 280:

MPC 59,90 eur za GRS 47,00 eur



DESCRIPTION

Built with a durable aluminum construction and medium length, the Black Diamond Quickdraw Probe Tour 280 is the go-to probe for day-in/day-out backcountry touring and snow study. The Tour 280's updated ferrules make for increased durability and quick alignment, while the integrated stuff sack and non-slip grip make for fast, one-pull deployment in emergency situations.

Updated dual Quickdraw speed ferrules make for extremely fast deployment with maximum durability

Rapid deployment stuffsack integrates with the probe's pull cord for one-pull readiness

Non-slip grip provides secure purchase, even with wet gloves

Oversized, durable alloy tip improves probing sensitivity by creating a hole larger

High-visibility 1 cm markings

TECH SPECS

Weight : 342 g (12 oz)

Length : 280 cm (110 in)

5. Black Diamond lopata Evac 7:

MPC 79,90 eur za GRS 59,99 eur



DESCRIPTION

Our top-of-the-line shovel for professional use, the Black Diamond Evac features a unique handle that can be set up in two configurations for digging test pits or rapid snow removal. The large blade moves lots of snow quickly, and a flat-bottom profile helps you get a good clean face on your pit wall. An extendable shaft and large D handle increase comfort for long days in the field involving multiple pits, and speed up digging time during an emergency.

Compact telescoping shaft and durable anodized blade

Shovel converts easily into hoe mode from the same attachment point for snow removal and excavation

Works with accessory winter saw attachment (sold separately) that attaches to the shaft for wood cutting and tree well extraction

Compact D-handle with comfortable dual-density grip

Evac 9 has larger blade volume and longer handle for professional use

TECH SPECS

Weight : [7] 794 g [9] 902 g

Blade Volume : [7] 2.65 L [9] 3.5 L

6. Black Diamond lopata Transfer 3:

MPC 49,90 eur za GRS 39,99 eur



DESCRIPTION

Built with an extendable handle and high-volume blade profile, the Black Diamond Transfer 3 Shovel helps you throw as much snow as possible from the smallest footprint. Its durable, smooth-bottom blade give you clean walls in your snow pit and the versatile design works well in any backcountry situation.

Extendable, removable trapezoidal shaft with a redesigned, anodized blade
Hybrid D/T handle

TECH SPECS

Weight : 692 g (1 lb 8 oz)

Blade Volume : 1.14 L (0.3 gal)

7. Black Diamond smučarski čevlji Quadrant:

MPC 479,00 eur uza GRS 339,99 eur



DESCRIPTION

Our most versatile alpine touring boot, the Black Diamond Quadrant combines lightweight skinning comfort with stiff freeride performance thanks to a 120 flex, tech binding compatibility and 40-degrees of resistance-free motion. The Quadrant's thermoformable, taped-seam liner has been redesigned for superior warmth and comfort on all-day, mid-winter tours. The rockered rubber outsole helps the boot pack go smoothly, and the four-buckle design gives you plenty of power when it's time to drop.

Triax Pivot frame with Flex 120, 40° of resistance-free touring motion and locking QuickWire buckles
Plastic liner tongue for a smooth, evenly distributed flex and a wide power strap
AT liner with reflective metalized Strobel base, articulated flex zones and taped seams for all-day cold-weather touring comfort
Rockered rubber outsole with integrated tech inserts provides dynamic grip and durability
103 mm V-shaped last with performance, out-of-box fit; 100% thermoformable

TECH SPECS

Weight Per Pair : [Size 27.5] 3.43 kg (7 lb 10 oz)

Boot Liner : Efficient Fit AT

Frame Technology : Triax Pivot

Flex Index : 120

Size: 24,0 – 30.5 (half size 24,5 25 25,5)

8. Black Diamond smučarske palice Traverse:

MPC 69,90 eur za GRS 49,99 eur

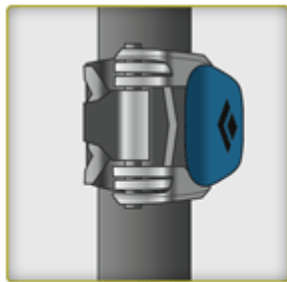

Low-profile design

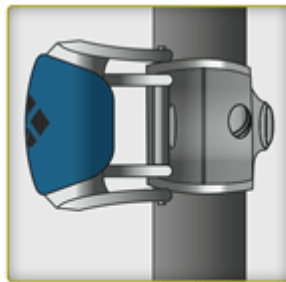

Dual-axle design for increased clamping leverage

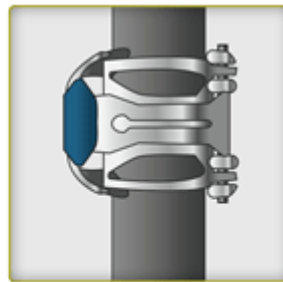

Stainless steel construction is durable and high quality

DESCRIPTION

Our classic workhorse adjustable pole, the Black Diamond Traverse features an all-aluminum construction to handle the beating dealt by day-in and day-out backcountry touring. Our FlickLock® Pro adjustability offers dramatically improved clamping force in a low-profile design, and the pole's Touring Series grip and strap provide lightweight, ergonomic comfort.

16 mm (.63 in) aluminum upper with 14 mm (.55 in) aluminum lower
Touring Series grip with fluted interior for weight reduction
Touring Series strap with lightweight webbing and plastic ladder-lock buckle
Lightweight grip extension for quick, secure choke-ups
100 mm (4 in) Powder Baskets
FlickLock Pro adjustability and security

Weight Per Pair : [95-145 cm] 585 g (1 lb 5 oz)
[105-155 cm] 600 g (1 lb 5 oz)
Usable Length : [95-145 cm] 95-145 cm (37-57 in)
[105-155 cm] 105-155 cm (41-61 in)
Collapsed Length : [95-145 cm] 95 cm (37 in)
[105-155 cm] 105 cm (41 in)

9. Black Diamond čelna svetilka Storm:

MPC 60,00 eur za GRS 44,00eur

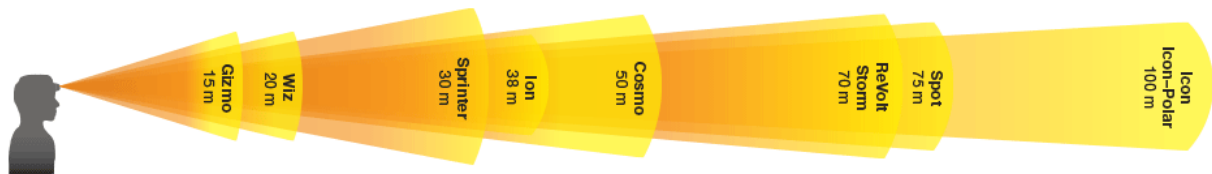

DESCRIPTION

Equipped with a fully waterproof construction and an incredibly bright 160 lumens, the Black Diamond Storm is our powerful, all-conditions headlamp. Now featuring our PowerTap Technology, the Storm allows for quick, on-the-fly brightness adjustment with just a finger tap to the side of its touch-sensitive housing. The Storm features a bright, precise beam for after-dark route-finding, as well as proximity, strobe, dimming and red night vision modes to accommodate any lighting needs. An intuitive lock mode also keeps the light from accidentally turning on when stored in your pack or pocket. One

QuadPower LED, two SinglePower white LEDs and two SinglePower red LEDs emit 160 lumens (max setting) PowerTap technology allows fast and simple transitioning between full and dimmed power in distance or proximity modes Red night-vision mode has proximity and strobe settings, and activates without cycling through the white mode Sleek, low profile design uses four AAA batteries and three-level power meter shows remaining battery life for three seconds after switching on headlamp Settings include: full strength in proximity and distance modes, dimming, strobe, red night vision and lock mode Protected against water immersion down to 1 m (3.3 ft) for 30 minutes (IPX 7)

TECH SPECS

Lumens : 160

Weight With Batteries : 110 g (3.9 oz)

Max Distances : [QuadPower LED] 70 m (230 ft)

[SinglePower LED] 7 m (23 ft)

Max Burn Time : [QuadPower LED] 200 H

[SinglePower LED] 125 H

IPX Rating : 7

LED Type : 1 QuadPower, 2 SinglePower

Batteries : 4 AAA (included)

10. Black Diamond čelna svetilka Spot

MPC 40,00 eur za GRS 29,00 eur

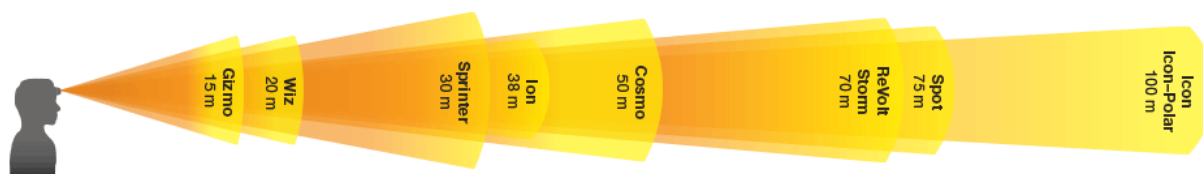

DESCRIPTION

With even more power and added features, the Black Diamond Spot Headlamp is our most popular headlamp for everything from late-night rappels to pre-dawn ski tours. Now with 130 lumens of bright, fully adjustable light, the Spot also features our new PowerTap Technology, which allows for quick, on-the-fly brightness adjustments with just a finger tap to the side of the Spot's touch sensitive housing. The Spot's bright, powerful beam is ideal for finding anchors or illuminating the trail, while its proximity mode handles camp tasks, tent reading and gearing up at the car. A handy lock mode keeps the light from turning on accidentally in your pack or pocket.

One TriplePower LED, two SinglePower white LEDs and two SinglePower red LEDs emit 130 lumens (max setting)

PowerTap Technology allows fast and simple transitioning between full and dimmed power in order to momentarily increase illumination in distance or proximity modes

Red night-vision mode has proximity and strobe settings, and activates without cycling through the white mode

Sleek, low profile design uses three AAA batteries and three-level power meter shows remaining battery life for three seconds after switching on headlamp

Settings include: full strength in proximity and distance modes, dimming, strobe, red night vision and lock mode

Protected against splashing or sprayed water from any angle (IPX 4)

TECH SPECS

Lumens : 130

Weight With Batteries : 90 g (3.2 oz)

Max Distances : [TriplePower LED] 75 m (246 ft)

[2 SinglePower LEDs] 15 m (49 ft)

Max Burn Time : [TriplePower LED] 50 hours

[SinglePower LEDs] 200 hours

IPX Rating : 4

LED Type : 1 TriplePower, 4 SinglePower (2 white, 2 red)

Batteries : 3 AAA (included)

11. Black Diamond dereze Serac (avtomatske, pol avtomatske, paščki)

MPC 129,00 eur za GRS 95,00 eur



TYPES OF CRAMPONS

PRO: Our most secure and adjustable system featuring a full step-in design for rigid-sole boots with both a toe and heel welt.

CLIP: A hybrid system with a toe strap and rear heel bail, designed for appropriate boots with a heel welt.

STRAP: Flexible toe and heel attachments for use with approach shoes or non-technical mountain boots

DESCRIPTION

A lightweight, 12-point crampon built for the variable, moderate terrain of classic mountaineering routes, the Black Diamond Serac crampon is available in three different configurations for maximum versatility with any type of mountain boot. Horizontal frontpoints provide secure bite in icy steps, while the serrated secondary points add more stability than the Sabretooth in steep snow and neve. The Serac's light and durable stainless steel design won't rust, resists snow balling and is free from toxic coatings that wear off in the mountains.

Distinctive stainless steel construction doesn't rust, is more durable, resists snow balling and saves weight

Versatile horizontal frontpoints and more stable secondary points

Low-profile micro-adjust heel bail with two positions

Pro version is for technical boots

Clip version is for boots without a front toe welt

Strap version is for use with trekking boots

Includes dual-density ABS

TECH SPECS

Weight Per Pair : [Clip] 938 g (2 lb 1 oz)

Size : One size fits 36-46. 46+ will require our long center bar.

Materials : Stainless steel

12. Black Diamond dereze Sabretooth (avtomatske, pol avtomatske)

MPC 139,00 eur za GRS 104,00 eur



DESCRIPTION

Equally at home in the Tetons as Chamonix, the Black Diamond Sabretooth crampon is our best all-around crampon for everything from moderate ice routes to big alpine faces. The Sabretooth's horizontal frontpoints provide secure bite on snow, alpine ice and rock edges, while the technical secondary points create a stable platform in softer conditions with more technical precision than the Serac. Serrated sub-points grab and hold when you're rocking over your feet. The Sabretooth's light, durable stainless steel construction won't rust, resists snow balling underfoot and is free from toxic coatings that can wear off in the mountains.

Distinctive stainless steel construction doesn't rust, is more durable, resists snow balling and saves weight

Versatile horizontal frontpoints and more technical secondary points

Low-profile micro-adjust heel bail with two positions

Pro version accommodates boots with a toe welt

Clip version features flexible toe strap for boots without a toe welt

Includes dual-density ABS

TECH SPECS

Weight Per Pair : [Clip] 925 g (2 lb 1 oz)

Size : One size fits 36-46. 46+ will require our long center bar.

Materials : Stainless steel

Za dodatne informacije smo vam na voljo:

Telefon: 01/4363654

Email: Shop@actionmama.com

www.actionmama.com